

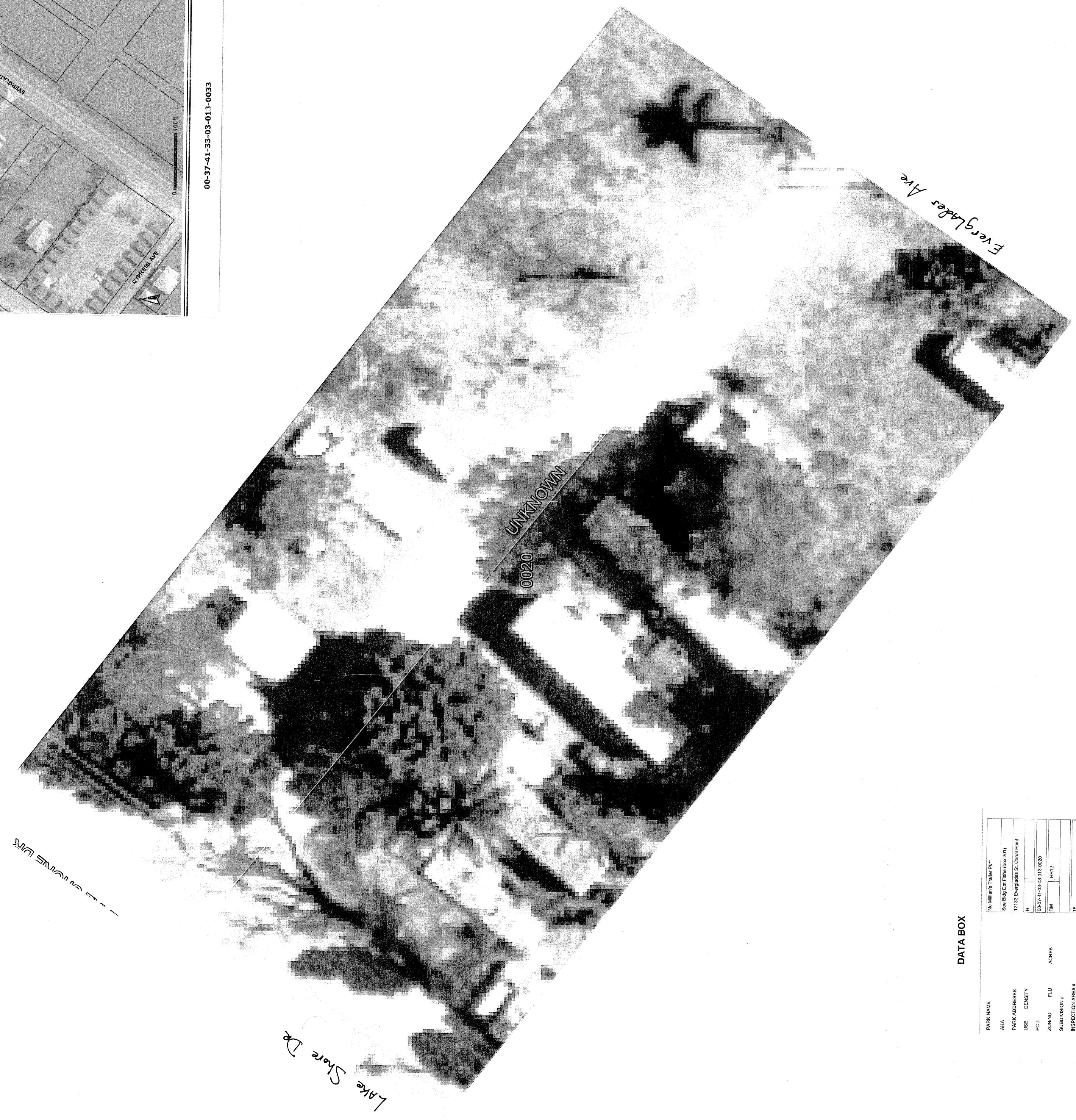

00-37-41-33-03-011-0033



**DATA BOX**

PARK NAME	Mc Millian's Trailer Park
AMA	See Map (or Phone Box 001)
PARK ADDRESS	1133 Everglades St. Coral Gables
USE	
DENSITY	
PC#	0037-41-33-03-011-0033
ZONING	RM
PLU	RT12
ACRES	
SUBDIVISION #	
INSPECTION AREA #	15
DATE OF APPROVAL	1984
IMPACT FEE ZONES	00000
PETITION #	
ZONING QUAD #	
NUMBER OF SPACES APPROVED	
ORDINANCE APPROVED UNDER	
RESOLUTION	
MAP MAPID	MRP-3230
SETBACKS	
DISCLAIMER:	Information in this data box is for informational purposes only. The information included in the data box and on the site plan is based solely upon information previously submitted by the applicant.

# McMillians Trailer Park

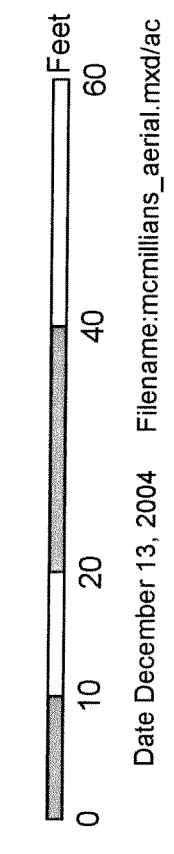

Date December 13, 2004 Filename:mcmillians\_aerial.mxd

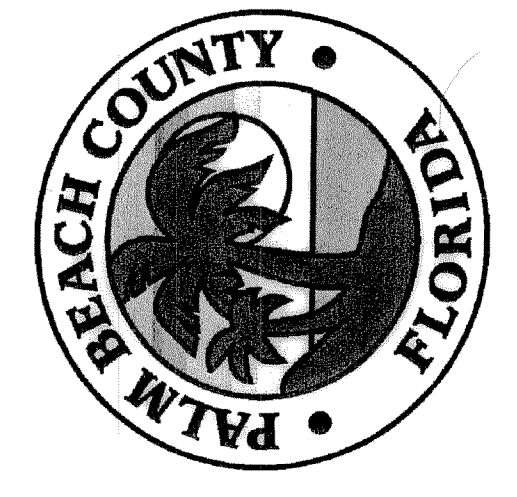

## Planning, Zoning and Building Department - GIS

100 Australian Avenue  
 West Palm Beach, FL 33406  
 (561) 233-5000  
 pzmap@co.palm-beach.fl.us  
 www.pbcgov.com/pzb